

Tree Survey 1:500 @A1

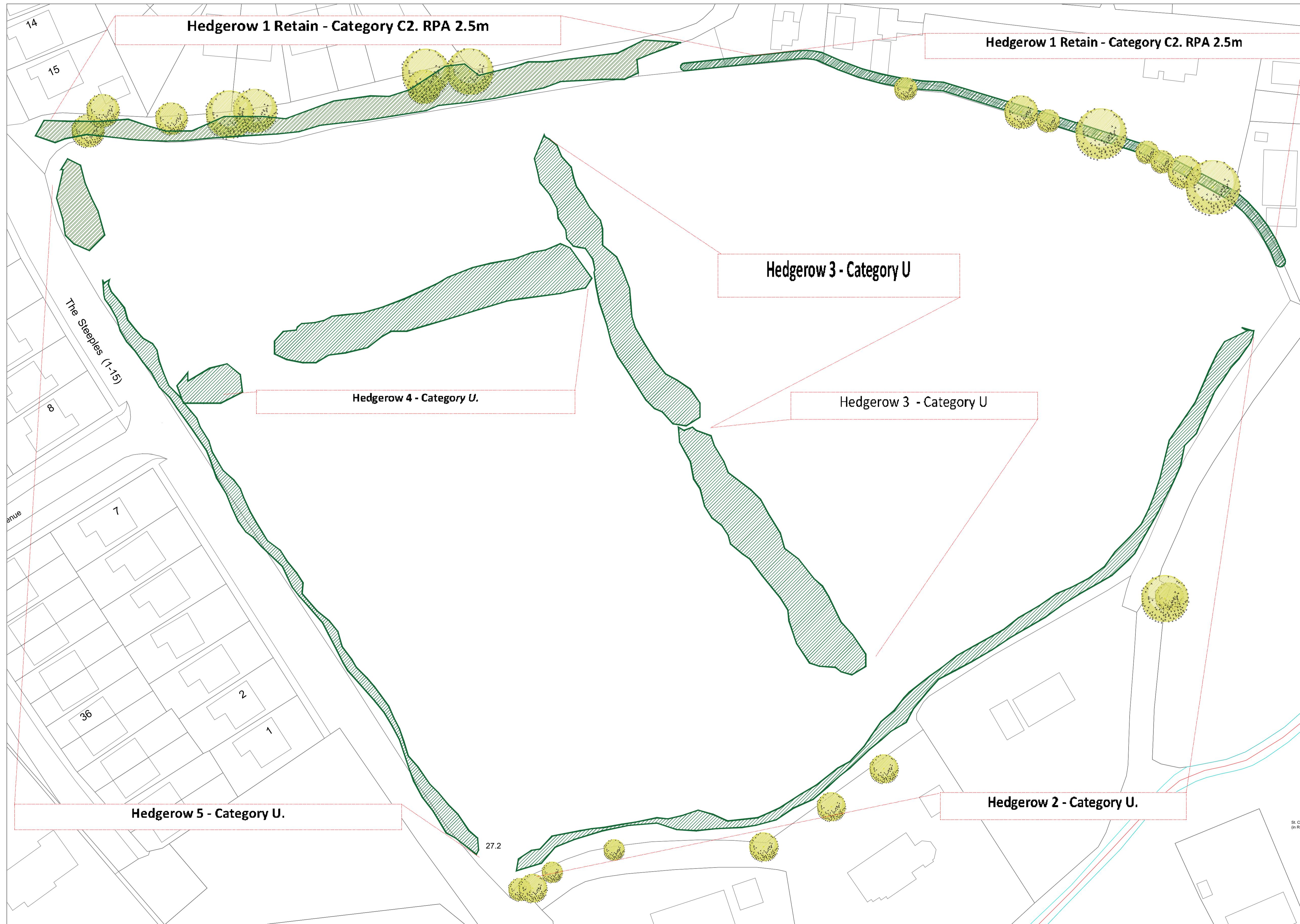

Rev.	Date	Description

Legend:

- Category ( A, A1, A2, A3 )  
Those of high quality and value: in such a condition as to be able to make a substantial contribution ( a minimum of 40 years )
- Category ( C, C1, C2, C3 )  
Those of low quality and value: currently in adequate condition to remain until new planting could be established ( a minimum of 10 years ) or young trees with a stem diameter below 150mm
- Category ( B, B1, B2, B3 )  
Those of moderate quality and value: those in such a condition as to make a significant contribution ( a minimum of 20 years )
- Category ( U )  
Those in such condition that any existing value would be lost within 10 years and which should, in the current context, be removed for reason of sound arboricultural management

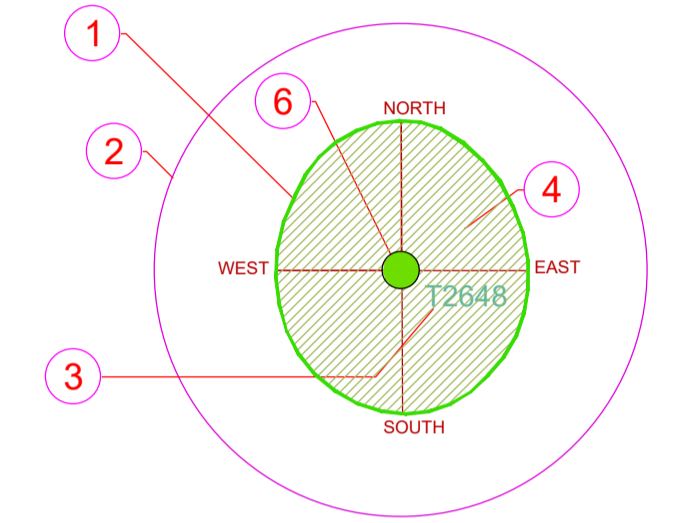

AGE GROUPINGS

- Y = YOUNG
- MA = MIDDLE AGE
- M = MATURE
- OM = OVER MATURE
- V = VETERAN

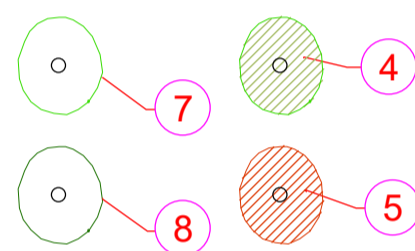

- 1 EXISTING TREE CANOPY BASED ON DIMENSIONS GATHERED ON SITE IN 4 DIRECTIONS, NORTH, SOUTH, EAST AND WEST
- 2 ROOT PROTECTION ZONE BASED ON 12 TIMES THE (DBH) AT CHEST HEIGHT
- 3 TREE TAG NUMBER
- 4 TREE TO BE RETAINED
- 5 TREE TO BE REMOVED
- 6 TREE CATEGORY BASED ON BS 5837-2012 CRITERIA
- 7 DECIDUOUS TREE CANOPY
- 8 EVERGREEN TREE CANOPY

01 TABLES BS 5837-2012

Key	
	Existing Tree
	Existing Hedgerow

Client:  
**DSPL Limited**

Project:  
**Proposed Residential Development at - Steeples Road, Duleek, Co. Meath**

Drawing Title:  
**Tree Survey**

Drawn By: HR	Checked By: MG	Date: 07.04.22	Scale: 1:500
Dwg. No. 1	CAD File:	Issued For: Planning	Rev. -

Arbor Care  
Unit 1a  
Crossagalla Enterprise Centre  
Ballysimon Road  
Limerick  
Ireland

Phone: +353 (0)863082808  
Fax: +353 (0)81400321  
Email: info@arborcare.ie  
Web: www.arborcare.ie

Approved  
Consultancy  
Service